

**SITE PLAN AS PROPOSED**

SCALE 1:500

**Occupancy Capacity Without Fixed Seating:**

(area/occupancy load factor)

Kitchen = 49 / 7 = 7

Play Area = 12.88 / 1 = 13

Staff Room = 12.7 / 1 = 13

**Occupancy Capacity Without Fixed Seating:**

New Cafe Area = 73

**Fire Escape Travel Distances:**

A = 6.61m

B = 19.61m

C = 16.55m

D = 19.03m

E = 16.37m

F = 12.58m

G = 11.84m

H = 10.84m

I = 22.49m

J = 11.77m

**Accessible Route 1:**

26.76m

**Accessible Route 2:**

8.06m

**Accessible Route 3:**

20.00m

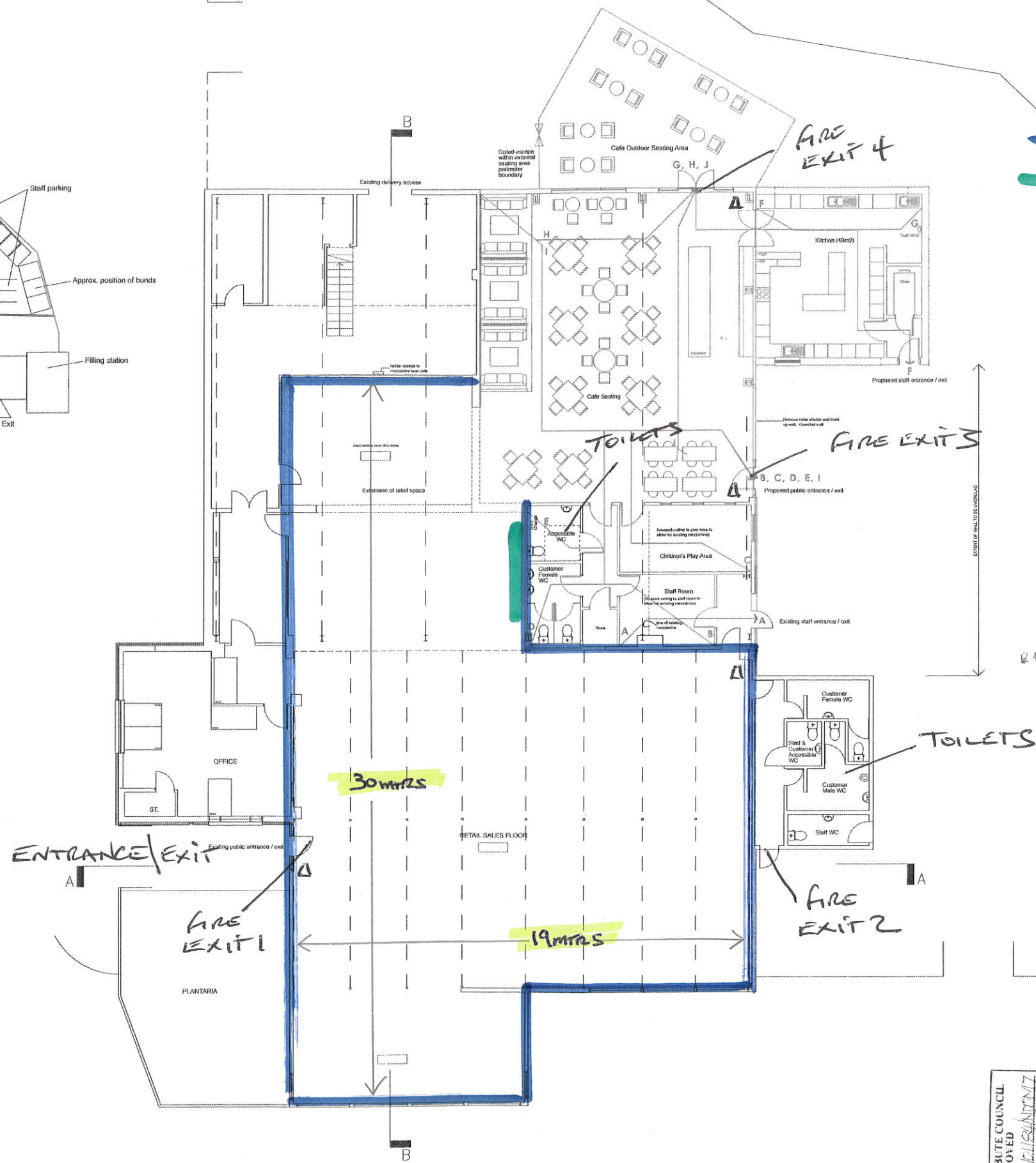

**GROUND FLOOR PLAN AS PROPOSED**

SCALE 1:100

ARGYLL STREET, DUNOON

PLAN 1

△ FIRE EXTINGUISHER

■ RETAIL SALES AREA

■ OFF-SALE DISPLAY

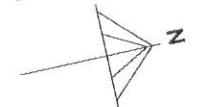

**Notes**

Copyright ARCHITECO 2017

Do not scale construction dimensions from this drawing. All dimensions are to be verified prior to construction.

**REVISIONS**

A - 6/12/16 - Site boundary indicated on 1:500 site plan. Proposed layouts & North orientation amended. Scale bars shown. Escape travel distances & occupancy take-off shown - C.J.J  
 B - 14/3/17 - Mezzanine stair omitted. Cafe layout revised. Externally accessed WC shown - C.J.J

**PROJECT**

**Proposed Alterations  
 Walkers Home & Garden  
 Centre  
 361 Argyll Street  
 Dunoon**

**DRAWING TITLE**

**Site & Floor Plan as Proposed**

SCALE DATE DRAWN BY

1:500 Aug 16 C.L.P

1:100

DRAWING NUMBER REVISION

**1249-03-12 B**

**ARCHITECO**

HOLISTIC DESIGN

info@architeco.co.uk www.architeco.co.uk  
 43 Argyll Street, Dunoon PA23 7HG 01369 701 988

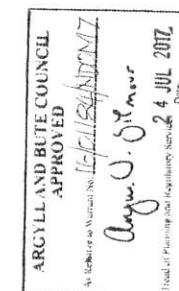



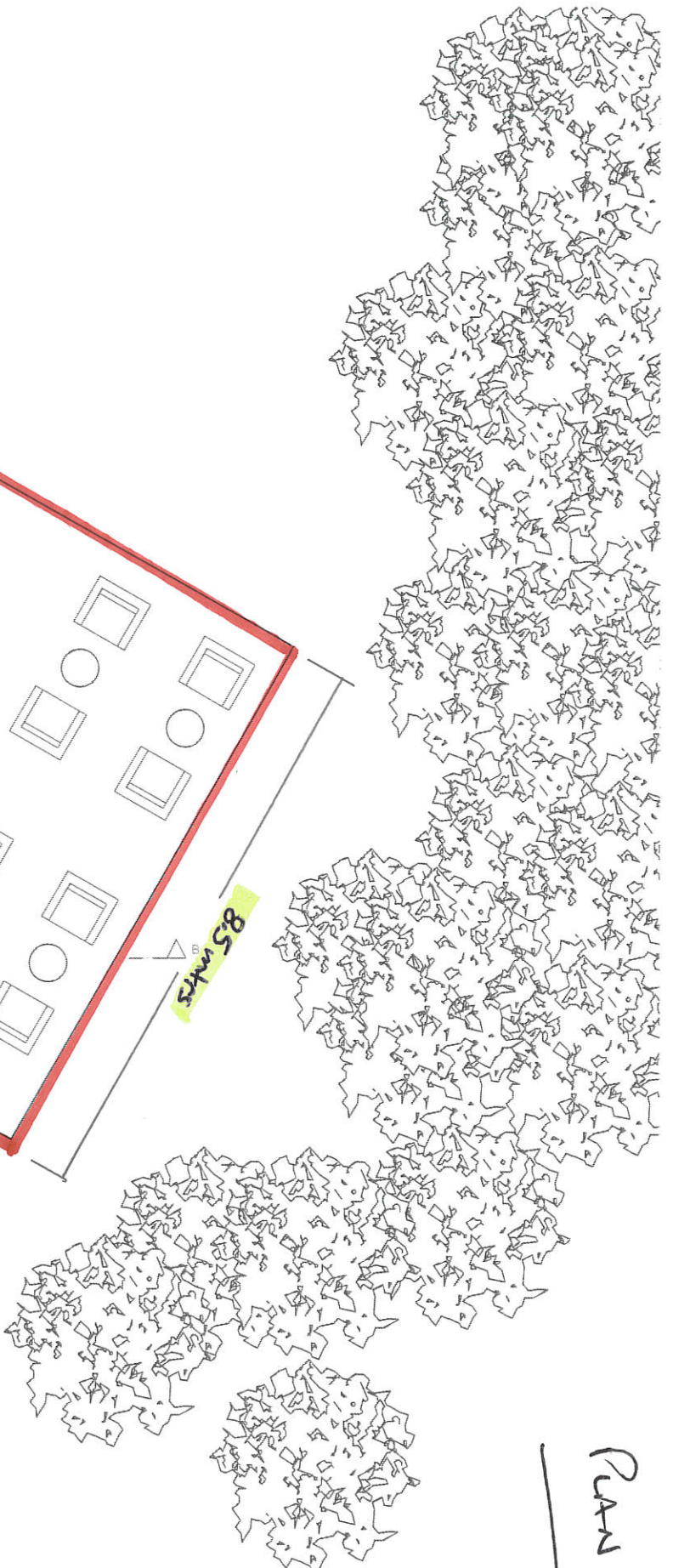

Plan 2



1:100 0 1 2 3 4 5 10

1  
1:100

<p><b>ARCHITTECO</b> SUSTAINABLE DESIGN &amp; LOW ENERGY BUILDING SPECIALISTS 43 Arqyll Street, Dunoon PA23 7HG info@architeco.co.uk 01369 701 988 www.architeco.co.uk</p> <p><b>Walkers Garden Centre</b></p>	Modified by <b>E.V.</b>	Date	Drawing Number <b>1249-03-50A</b>	Revision History																													
	Checked by <b>C.L.P.</b>	Date	Drawing Name <b>Part Ground Floor Plan Cafe 100</b>																														
	Drawing Scale <b>1:100</b>			<table border="1"> <thead> <tr> <th>Revid</th> <th>CHD</th> <th>Change Name</th> <th>Date</th> </tr> </thead> <tbody> <tr> <td>A</td> <td>C.J.J</td> <td>Layout revised</td> <td>19/4/17</td> </tr> <tr> <td></td> <td></td> <td></td> <td></td> </tr> <tr> <td></td> <td></td> <td></td> <td></td> </tr> <tr> <td></td> <td></td> <td></td> <td></td> </tr> <tr> <td></td> <td></td> <td></td> <td></td> </tr> <tr> <td></td> <td></td> <td></td> <td></td> </tr> </tbody> </table>		Revid	CHD	Change Name	Date	A	C.J.J	Layout revised	19/4/17																				
	Revid	CHD	Change Name	Date																													
A	C.J.J	Layout revised	19/4/17																														



Plan 3

# CAFE

## INTERNAL ELEVATION AS PROPOSED

## Side Elevation

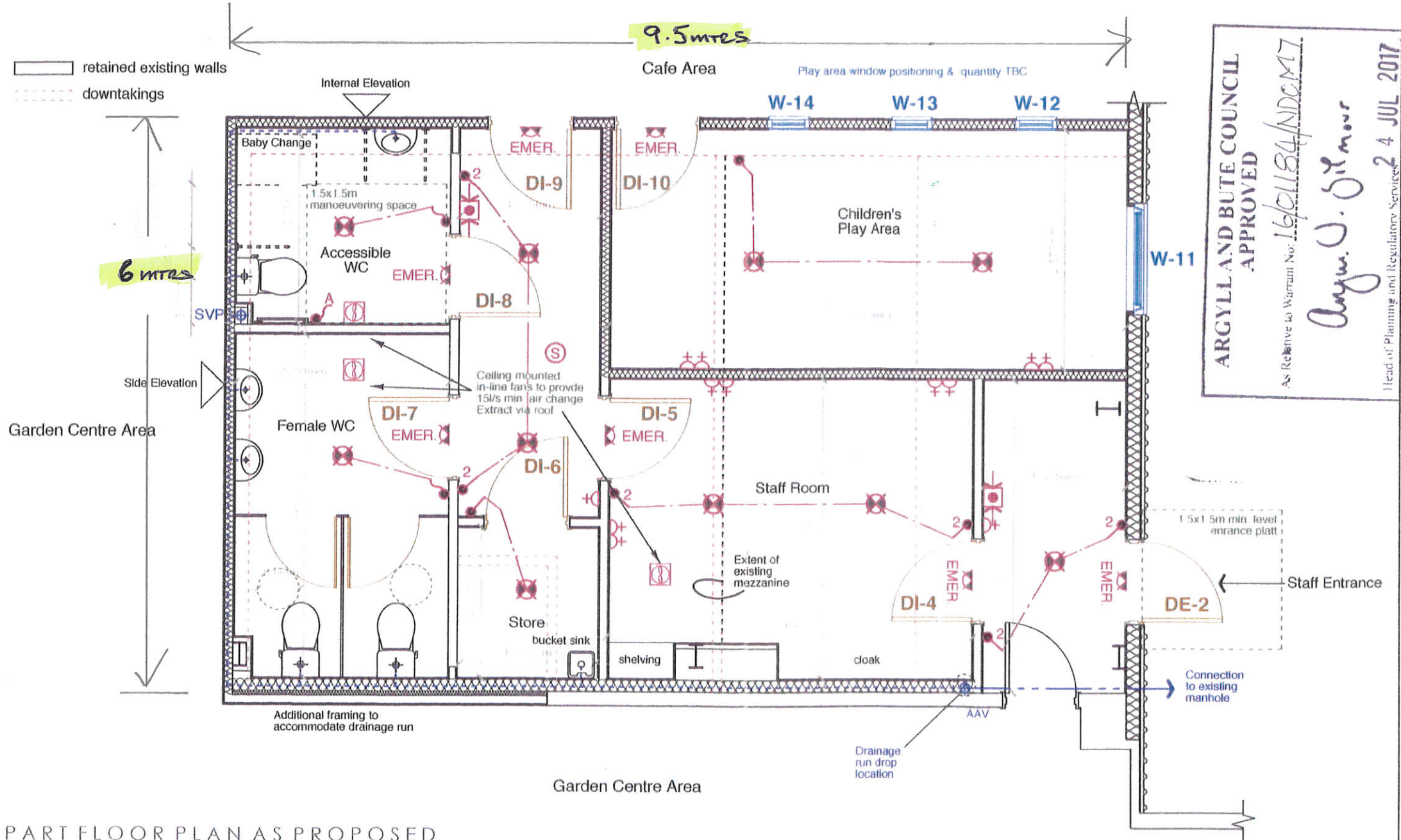

## PART FLOOR PLAN AS PROPOSED

### Notes

Copyright ARCHITECO 2017  
 Do not scale construction dimensions from this drawing. All dimensions are to be verified prior to construction.

### REVISIONS

A - 9/12/16 - Emergency lighting shown in play/staff & toilet areas. Accessible WC revised. Staff ventilation provision shown. Proposed mezzanine staircase & accessible platt shown. Additional insulation shown. Door DI-10 position amended.  
 B - 14/3/17 - Existing partition between cafe and play room amended to timber kit. Mezzanine staircase omitted.

### PROJECT

**Proposed Alterations  
 Walker's Home & Garden  
 Centre  
 361 Argyll Street  
 Dunoon**

### DRAWING TITLE

**Part Floor Plan & Internal  
 Elevation as Proposed**

SCALE DATE DRAWN BY

1:50 Sep 2016 C.J.J

DRAWING NUMBER REVISION

**1249.03-33 B**

**ARCHITECO**

HOLISTIC DESIGN

ARCHITECO 43 Argyll Street, Dunoon PA23 7HG  
 info@architeco.co.uk 01369 701 988 www.architeco.co.uk